

CSM 300N

Conduction-cooled capacitor

Technology Patented Worldwide

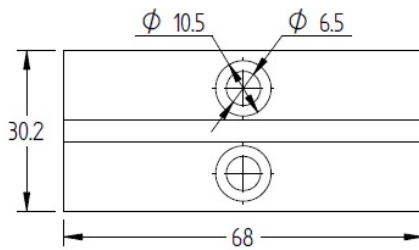
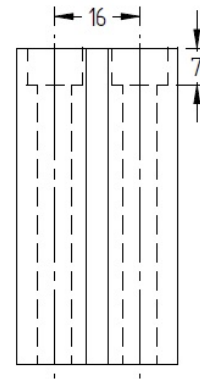
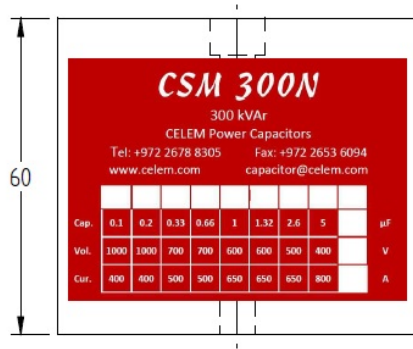

It is a 300kVAr capacitor with same structure and dimensions as the old CSM300, but it utilizes the most advance Celem soldering technology which provides a wider power safety margin, and improves the longevity of the capacitor.

Specifications

Type		CSM 300N							
Dimensions (L x W x H)	mm	68 x 60 x 30.2							
Weight	kg	0.55							
Capacitance (±10%)	µF	0.1µF	0.2µF	0.33µF	0.66µF	1µF	1.32µF	2.6µF	5µF
Sinusoidal Voltage	V _{rms}	1000	900	800	700	600	500		
Peak Voltage	V	1410	1270	1130	990	850	710		
Max. Current	A _{rms}	400	500	650	650	800			
Max. Power	kVA _r	300							
Freq Range @ Full Power	kHz	478-849	239-425	179-402	113-201	97-224	74-170	51-86	38-68
Stray Inductance	nH	< 5							

Celem Power Capacitors

Produced: 03-09-2015

CSM 300N

Conduction-cooled capacitor

Technology Patented Worldwide

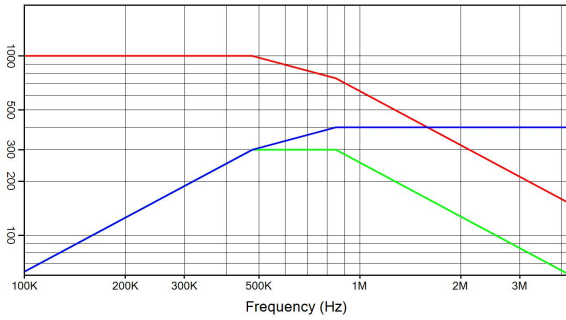

CSM 300N 0.1 μF 1000 V_{rms} 400 A_{rms} 300 kVA_r
 I(A) — Q(kVA_r) — V_{rms}

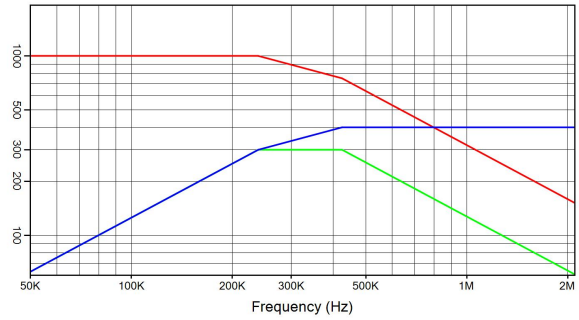

CSM 300N 0.2 μF 1000 V_{rms} 400 A_{rms} 300 kVA_r
 I(A) — Q(kVA_r) — V_{rms}

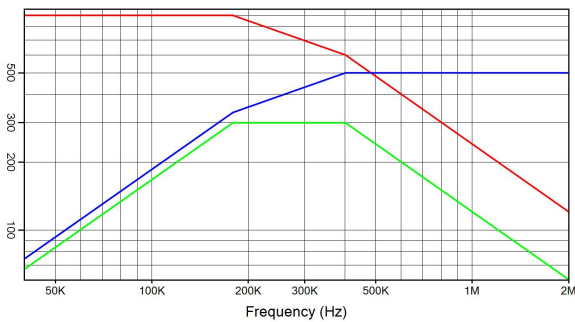

CSM 300N 0.33 μF 900 V_{rms} 500 A_{rms} 300 kVA_r
 I(A) — Q(kVA_r) — V_{rms}

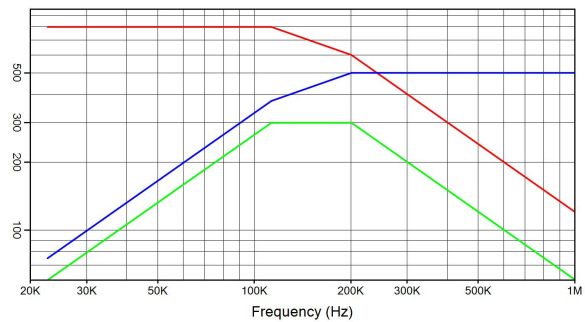

CSM 300N 0.66 μF 800 V_{rms} 500 A_{rms} 300 kVA_r
 I(A) — Q(kVA_r) — V_{rms}

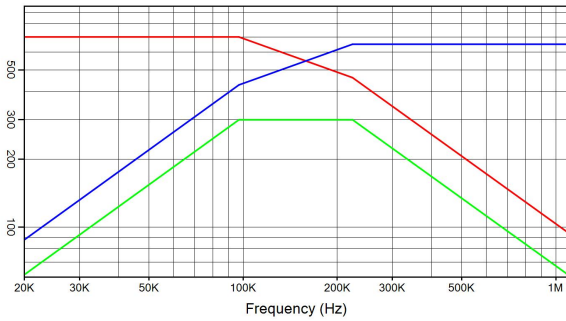

CSM 300N 1 μF 700 V_{rms} 650 A_{rms} 300 kVA_r
 I(A) — Q(kVA_r) — V_{rms}

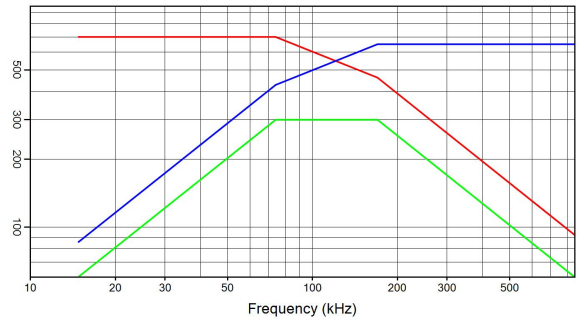

CSM 300N 1.32 μF 700 V_{rms} 650 A_{rms} 300 kVA_r
 I(A) — Q(kVA_r) — V_{rms}

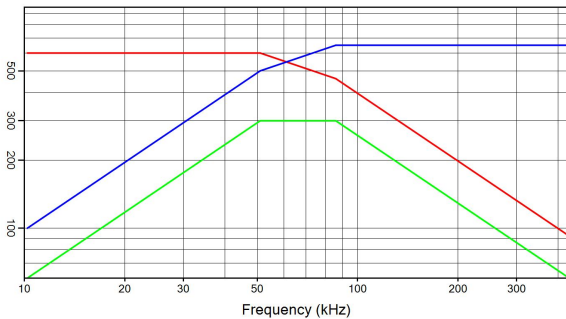

CSM 300N 2.6 μF 600 V_{rms} 650 A_{rms} 300 kVA_r
 I(A) — Q(kVA_r) — V_{rms}

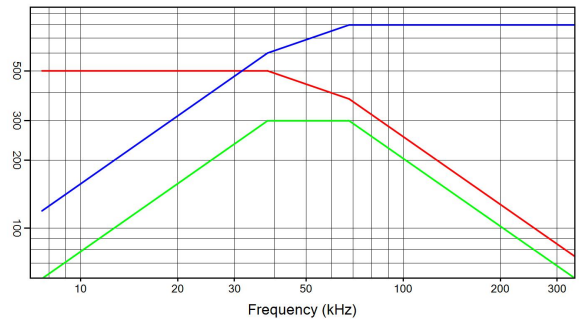

CSM 300N 5 μF 500 V_{rms} 800 A_{rms} 300 kVA_r
 I(A) — Q(kVA_r) — V_{rms}

Celem Power Capacitors

Produced: 03-09-2015